

Important Facts

- ◆ MetroLink will operate normally during the construction project.
- ◆ The Grand MetroLink Station will be temporarily closed during the beginning of the construction project. The station will reopen in Spring 2011.
- ◆ The #70 Grand, #58X Twin Oaks Express, and #410X Eureka Express will be rerouted around the construction. See the diagram inside for more information.
- ◆ MetroBus customers traveling through the construction area should plan an extra 10-15 minutes for their trips.
- ◆ MetroBus customers traveling outside the construction area will experience regular service.
- ◆ The Grand Bridge construction project is scheduled to be completed in 18-24 months.
- ◆ When completed, the new Grand Bridge will feature wider sidewalks, improved traffic flow with built-in bus pullout lanes, and spacious shelters to protect Metro customers from the weather.
- ◆ During the construction project, Metro will redesign the Grand MetroLink Station and create a Scott Avenue Transit Plaza, which will feature seating, vending, attractive landscaping, improved lighting, and a new park-ride lot.

The Grand MetroLink Station will reopen in Spring 2011, allowing customers to use the station safely during construction.

The New Grand Bridge and Scott Avenue Transit Plaza

The new Grand Bridge will feature improvements that will benefit transit riders and pedestrians, and improve traffic on the bridge. The new bridge will have wider, ADA-compliant sidewalks and four divided lanes of traffic with added bus pullouts, which will prevent buses from having to stop in traffic lanes. For transit riders making bus connections on the bridge, spacious wind and rain shelters will protect them from the weather.

While the City of St. Louis replaces the Grand Bridge, the Grand MetroLink Station will also undergo a substantial redesign that will transform the station into the Scott Avenue Transit Plaza. The new transit plaza will feature seating, a vending area, attractive fencing and landscaping, improved lighting and a 58 space park-ride lot.

For information on these projects, visit Metro's blog at www.nextstopstl.org.

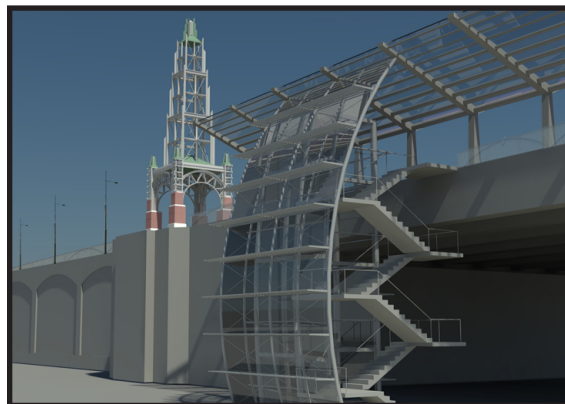

For more information:
Visit www.metrostlouis.org or
contact Metro Transit Information
314-231-2345 or 618-271-2345

CM11033



Metro

Grand Bridge Construction

March 2011



The Grand Bridge is coming down. When that happens, your commute may change.

The City of St. Louis is replacing the Grand Bridge. The project will take 18-24 months. Here's how the construction project may affect your commute.

How will this affect MetroLink?

During select weekends, there will be no MetroLink service between the Central West End and the Union Station MetroLink Stations. During those times, buses will transport customers. Metro will alert customers in advance of any changes.

For the first two to three weeks, customers who normally use the Grand MetroLink Station will need to board and deboard at the Union Station MetroLink Station to connect with the #70 Grand bus. The #70 Grand bus will serve areas surrounding the Grand MetroLink Station.

How will this affect MetroBus?

The #70 Grand will be rerouted to the Union Station MetroLink Station during the temporary closure of the Grand MetroLink Station. Customers will need to use the #70 Grand bus to reach destinations surrounding the Grand MetroLink Station.

For the entire 18-24 month construction period, customers traveling on **#70 Grand**, **#58X Twin Oaks Express** and **#410X Eureka Express** may need to make changes to their commutes. Please see the following panels for details.

#70 Grand

Customers traveling through the construction area on the #70 Grand will need to plan an extra 10-15 minutes for their trips. Travel times will depend on traffic.

With the demolition of the Grand Bridge, the #70 Grand will no longer be able to travel on Grand between Chouteau and Lindell. Below are #70 Grand reroute maps that show how to travel around the construction area both north and southbound. Customers will be able to connect with the #70 Grand from the Grand MetroLink Station*, and from any bus stop located on the reroutes.

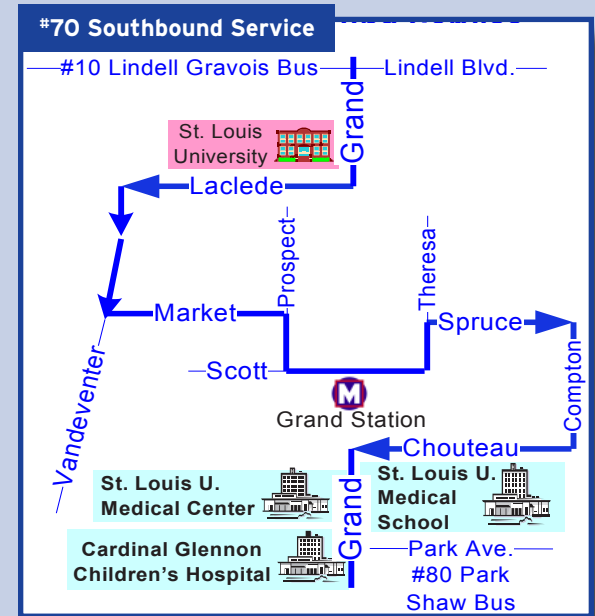
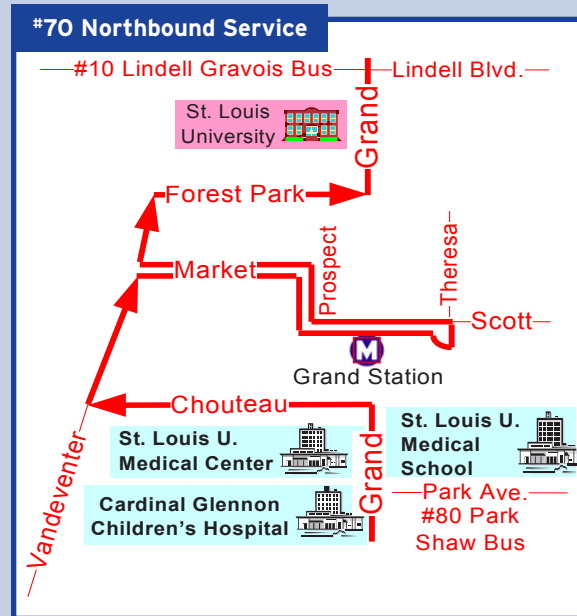

**The above maps of the #70 Grand apply when the Grand MetroLink Station is reopened. During the temporary closure of the Grand MetroLink Station, the #70 Grand will travel east to the Union Station MetroLink Station to pickup customers, and use Market or I-64 to reconnect to Grand.*

#58X Twin Oaks Express and #410X Eureka Express

The #58X Twin Oaks Express and #410X Eureka Express will not travel on Grand between Chouteau and Lindell. Instead, both buses will be rerouted around the construction via Chouteau and Compton.

Customers who use the #58X Twin Oaks Express or the #410X Eureka Express to travel to or from locations north of Chouteau will need to transfer to the #70 Grand at Park.

