

## Schematic Layout of Transit Centers: MO

Schematic maps showing details of bus bay allocations for routes at each of the MetroBus Transit Centers can be accessed by scrolling down this document in the order as listed below.

### **Ballas Transit Center**

Address: 790 South New Ballas, Town & Country, St. Louis, MO 63141  
Parking Spaces: 80  
MetroBus Routes: #48, 49, 58, 98, 57X, 158, 258

### **Catalan Loop**

Address: 8610 South Broadway, St. Louis, MO 63111  
Parking Spaces: None  
MetroBus Routes: #8, 40, 48, 90

### **Central West End Transit Center**

Address: 410 South Euclid St, St. Louis, MO 63110  
Parking Spaces: None  
MetroBus Routes: #1,10, 13, 59, 80, 95, 57X

### **Civic Center Transit Center**

Address: 401 S 14<sup>th</sup> St, St. Louis, MO 63103  
Parking Spaces: None  
MetroBus Routes: # 4, 8, 10, 11, 30, 32, 41, 74, 80, 94, 97, 36X, 58X, 174X, 410X MetroLink Station: Civic Center

### **Clayton Transit Center**

Address: 275 S. Central Ave., St. Louis, MO 63105  
Parking Spaces: 800 (fee)  
MetroBus Routes: # 1, 47, 58, 66, 97, 158, 258 MetroLink Station: Clayton

### **Delmar Loop Station**

Address: 660 Rosedale Ave., St. Louis, MO 63112  
Parking Spaces: 362  
MetroBus Routes: #2, 16, 91, 97 MetroLink Station: Delmar Loop

### **Hampton Loop**

Address: 7315 Gravois, St. Louis, MO 63101  
Parking Spaces: None  
MetroBus Routes: #10, 95, 110

### **Maplewood-Manchester Station**

Address: N Forty Drive @ New Ballas Road, St. Louis, MO 63143  
Parking Spaces: None  
MetroBus Routes: # 2, 32, 57 MetroLink Station: Maplewood-Manchester

### **North Broadway Taylor Transit Center**

Address: 6206 North Broadway, St. Louis, MO 63147  
Parking Spaces: None  
MetroBus Routes: # 18, 42, 70, 95

### **North Hanley Station**

Address: 4398 Hanley Road, Berkeley, MO 63134  
Parking Spaces: 1583  
MetroBus Routes: # 4, 34, 35, 36, 44, 45, 47, 49, 61, 75, 98 MetroLink Station: North Hanley

### **Riverview MetroBus Center**

Address: 9000 Riverview, St. Louis, MO 63137  
Parking Spaces: 45  
MetroBus Routes: #16, 27, 36, 40, 41, 90, 36X

### **Rock Road Station**

7019 St. Charles Rock Rd., St. Louis, MO 63133  
Parking Spaces: 183  
MetroBus Routes: #2, 30, 32, 33, 35, 64 MetroLink Station: Rock Road

### **Shrewsbury - Lansdowne I-44 Station**

Address: 7201 Lansdowne Ave., St. Louis, MO 63119  
Parking Spaces: 800 (25 Long-Term)  
MetroBus Routes: #11, 16, 17, 21, 30, 46, 56, 210 MetroLink Station: Shrewsbury - Lansdowne I-44

# BALLAS METROBUS CENTER

Effective Date: August 30, 2010

Ballas Rd

I-64 Ramp

SPEED LIMIT 10



Call A Ride



ONE WAY



MoDot

#98 To Hanley Station  
#258 To Clayton Station  
#58 To Clayton Station

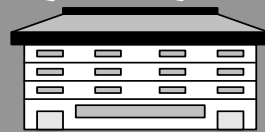

Ballas Transfer Center

ONE WAY

#48 Lindbergh South  
#98 To Chesterfield  
#258 To Chesterfield  
#158 To Delmar Gardens



# Catalan Loop

Effective Date: August 30, 2010

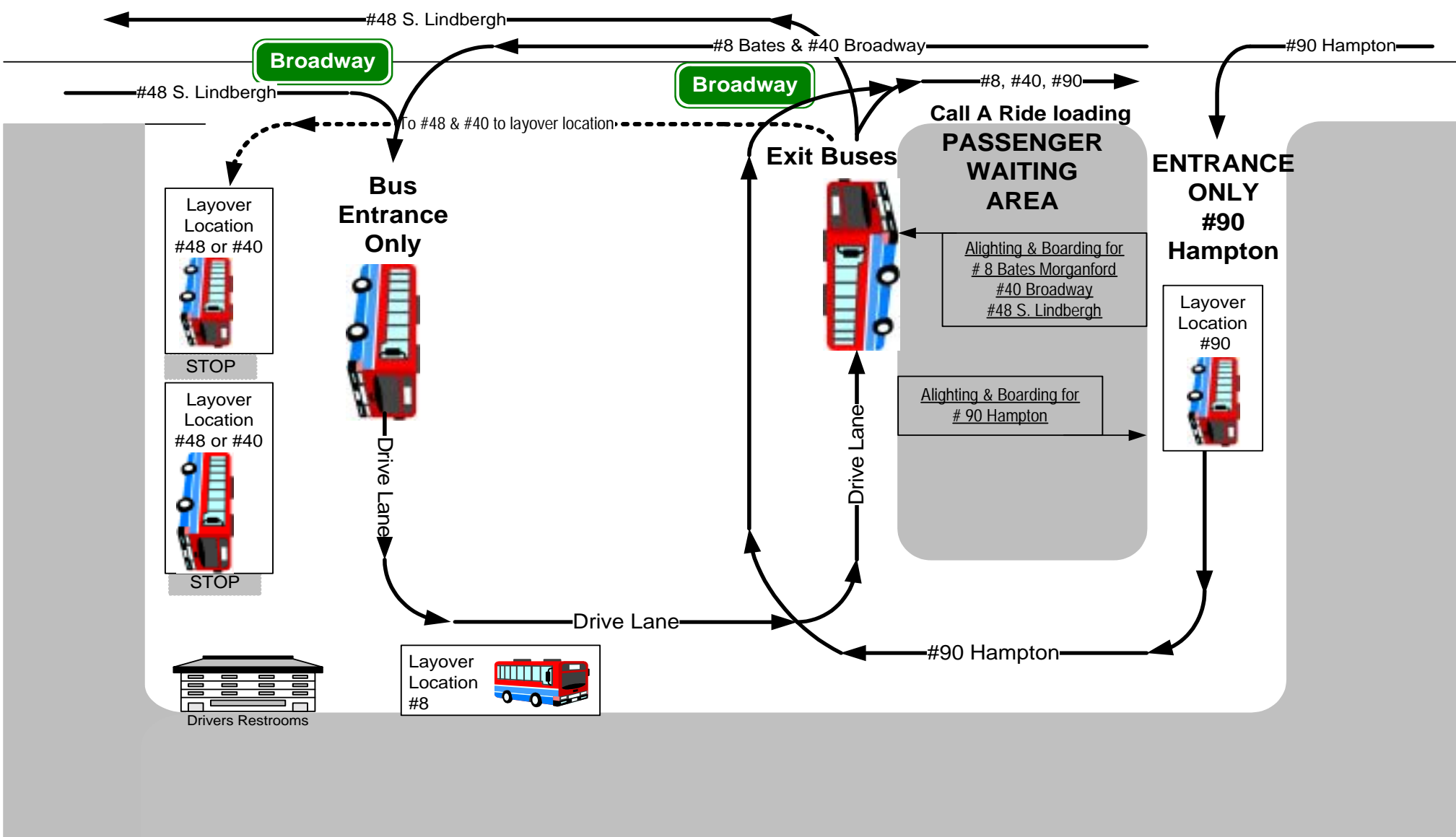
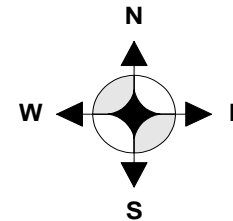



Metro

# CENTRAL WEST END METROBUS CENTER

Effective Date: November 26, 2012

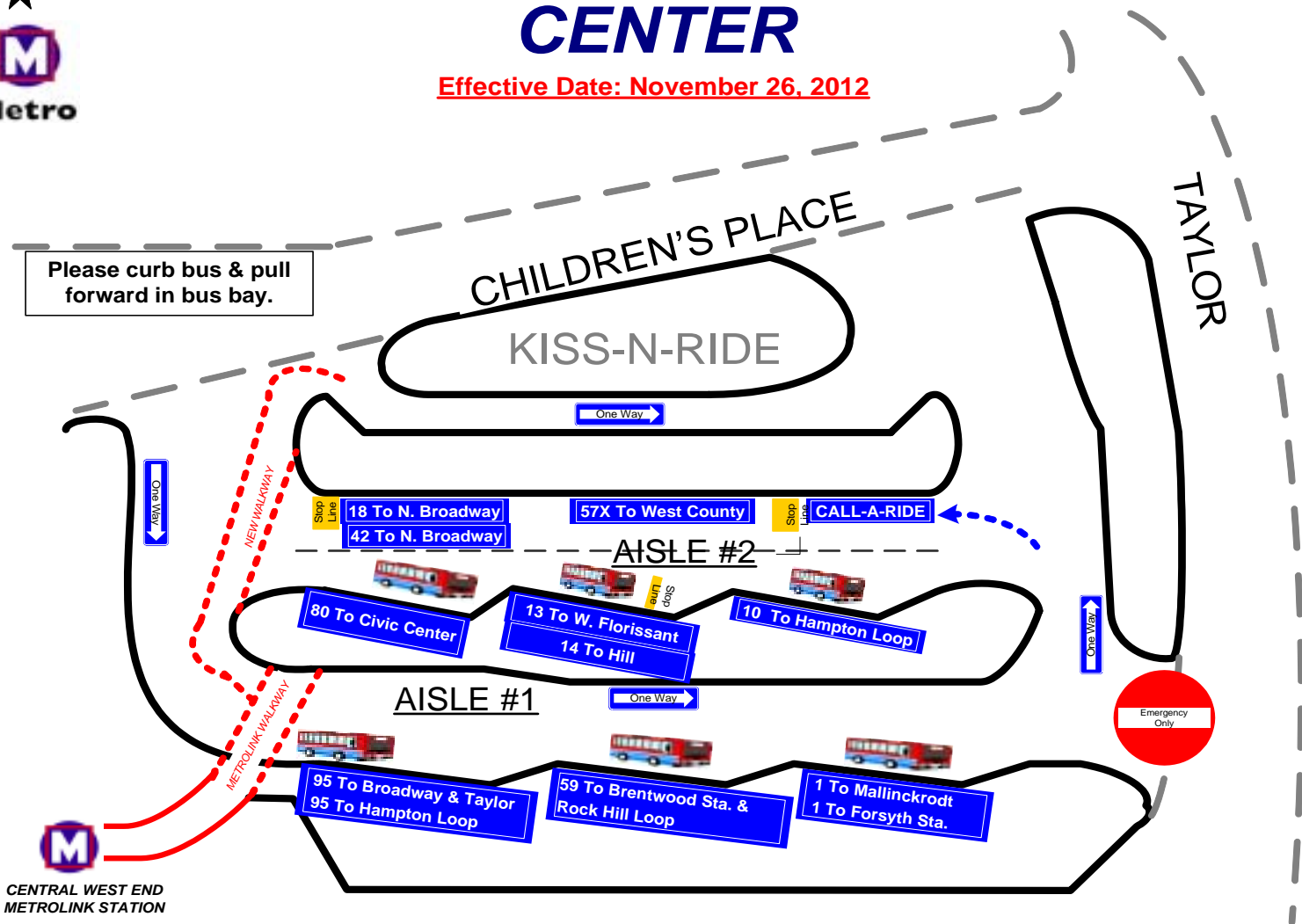

# Effective Date: January 9, 2012

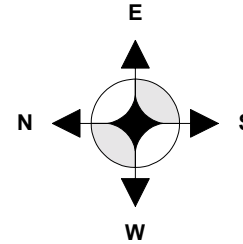

Spruce Street

- ON SPRUCE**
- #36X Bissell Hills Express (AM)
  - #58X Twin Oaks Express (PM)
  - #174X Halls Ferry Express (AM)
  - #410X Eureka Express (PM)

- ON SPRUCE**
- #36X Bissell Hills Express (PM)
  - #58X Twin Oaks Express (AM)
  - #174X Halls Ferry Express (PM)
  - #410X Eureka Express (AM)

Clark Street

Buses will not serve this stop

14<sup>th</sup> Street

- #4 Natural Bridge
- #10 Gravois Lindell  
To Hampton Loop
- #11 Chippewa
- #30 Souldard  
To Shrewbury Station
- #32 ML King Chouteau  
To Maplewood Station
- #41 Lee
- #97 Delmar

North Exit

North Entrance

South Exit Entrance



**Civic Center Transit Center**

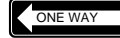

Civic Center MetroLink Station

#40X I-55 Express (PM) #99 Downtown Trolley

#74 Florissant

#8 Bates Morganford  
#80 Park Shaw

#94 Page

#73 Carondelet

#32 ML King Chouteau  
#40X I-55 Express (AM)

#10 Gravois Lindell To CWE Station  
#30 Souldard To Rock Rd. Station

# CLAYTON TRANSFER CENTER

Effective Date: March 12, 2012



**Metro**

Parking  
Garage  
Exit

Parking  
Garage  
Entrance

SPEED  
LIMIT  
5



1 Gold

47 North Hanley

97 Delmar

SPEED  
LIMIT  
5

South Meramec

South Central

Call a Ride



58 Clayton Ballas

258 Clayton Chesterfield  
158 Ballas West County

66 Clayton Airport

Monsanto Shuttle

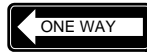

Shaw

# DELMAR STATION

Effective date: November 28, 2011



METROLINK

Enright



Des Peres

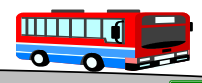

#91 Olive



#97 Delmar

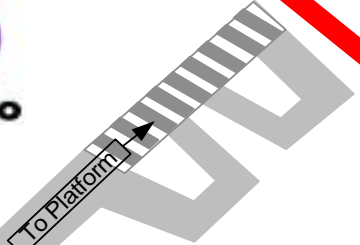

#16 City Limits To Shrewsbury Station

Rosedale

#16 City Limits To Riverview TC

#2 Red Line

Delmar

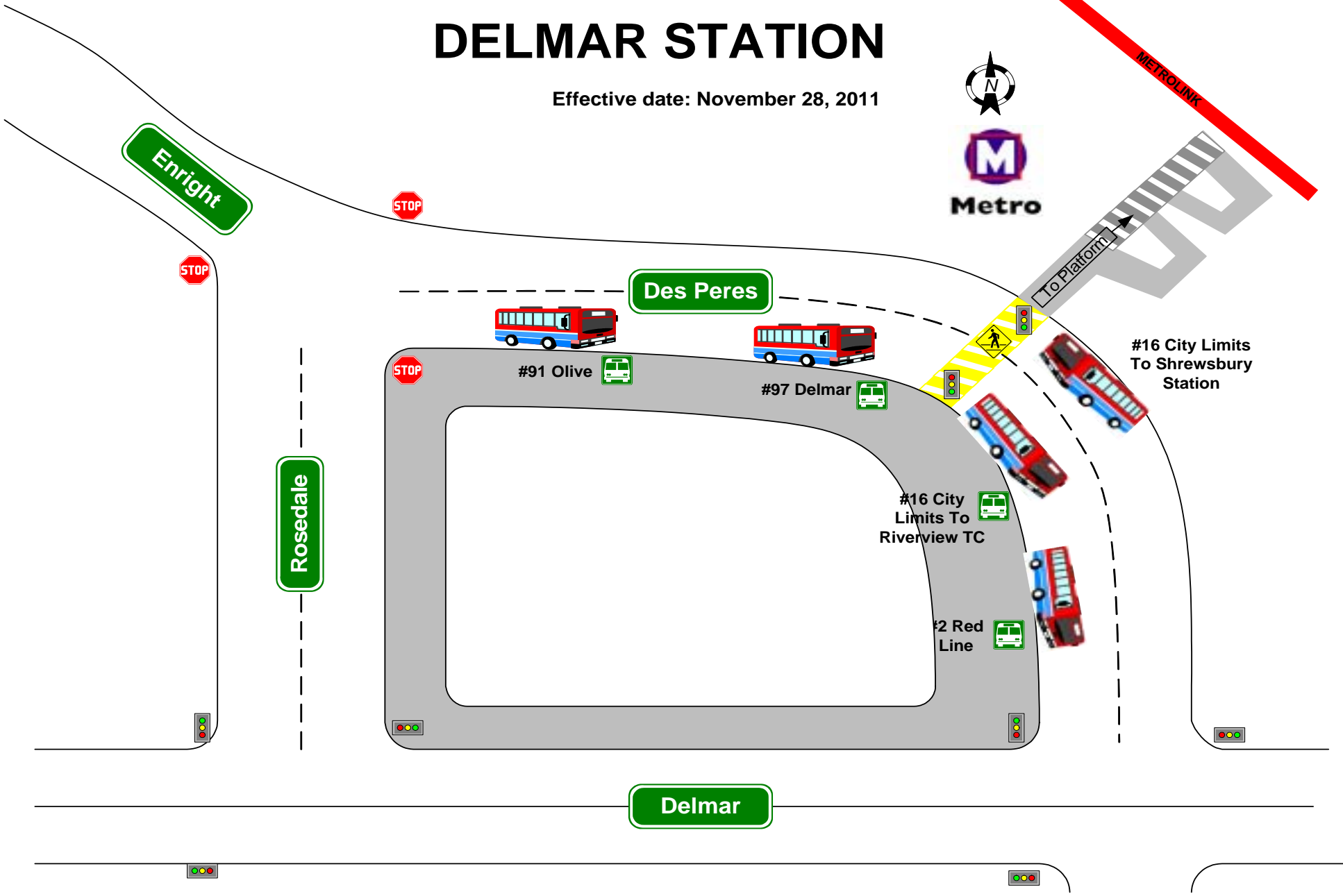

# GRAVOIS-HAMPTON TRANSIT CENTER

Effective January 24, 2011

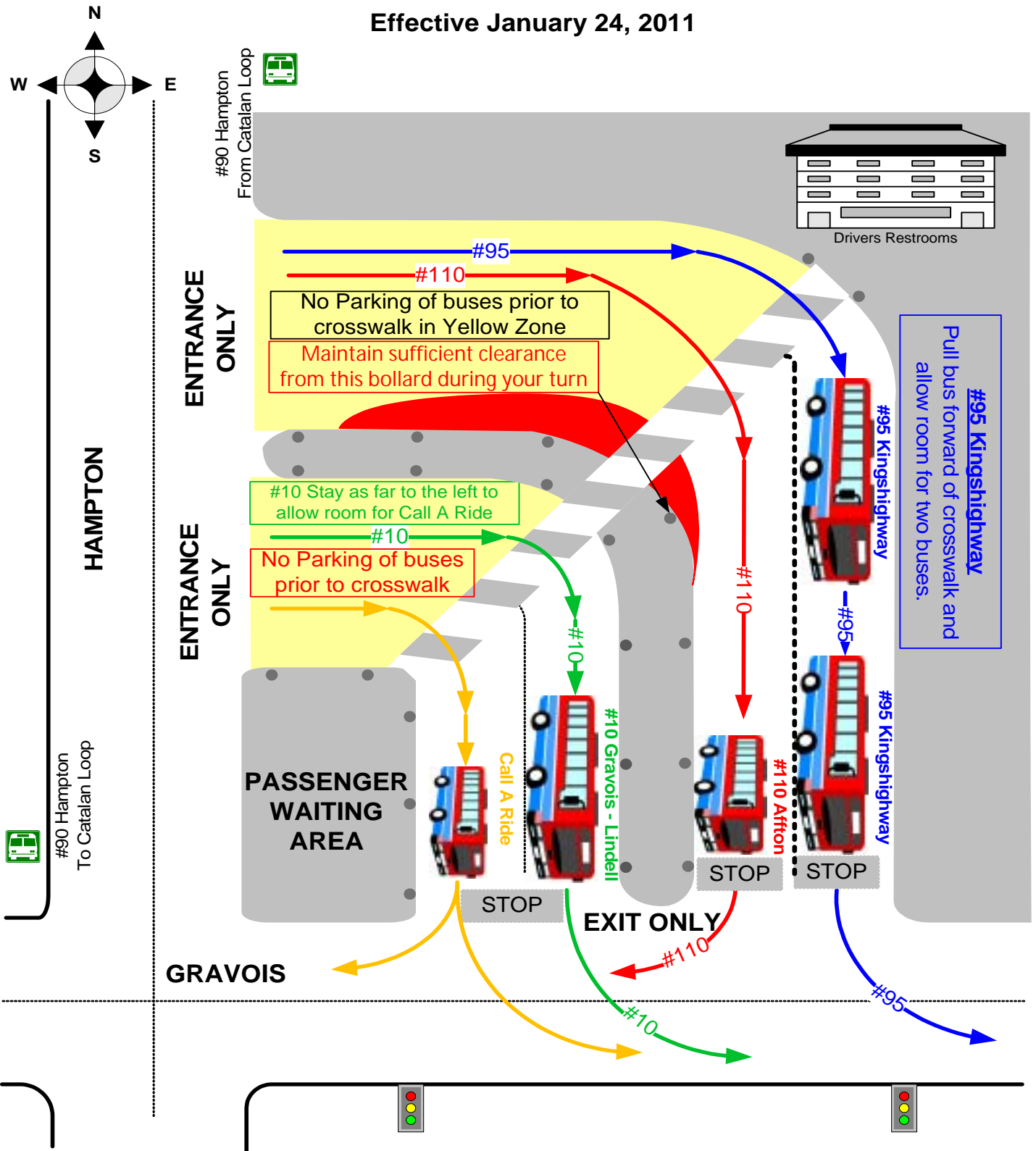



# MAPLEWOOD LOOP

Effective: November 29, 2010

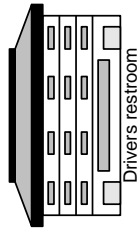
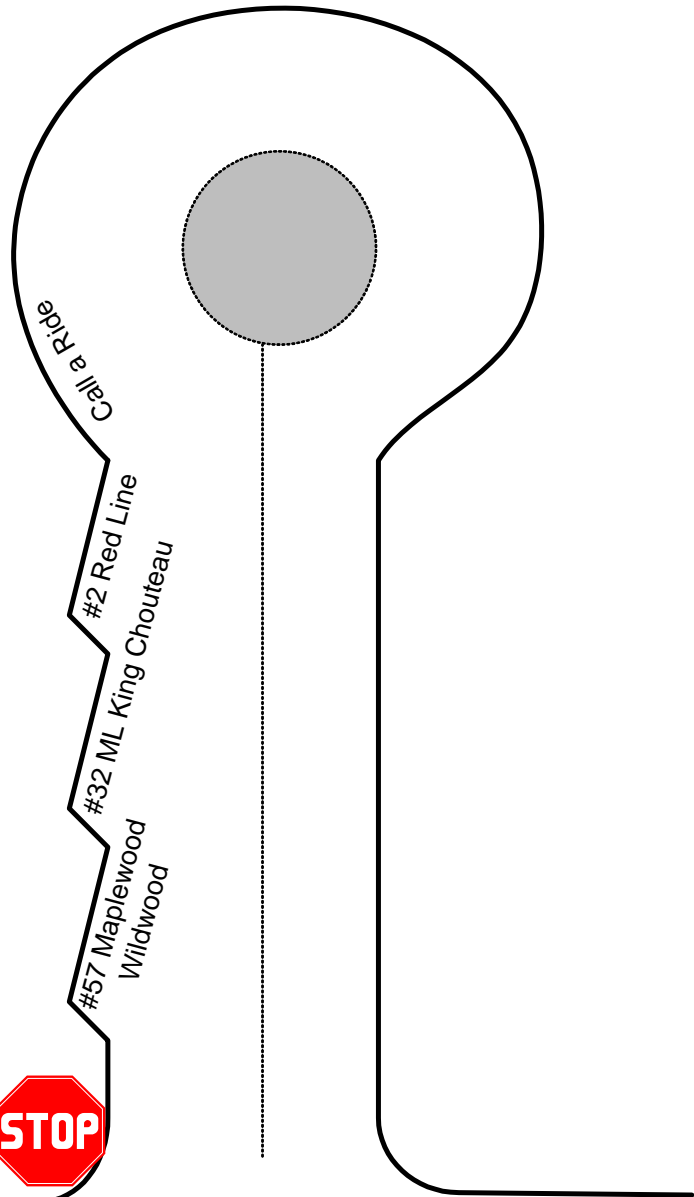
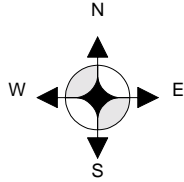

Maplewood Station Platform

Stairs to platform

Elevator

Manchester

Stairs to platform

# NORTH BROADWAY METROBUS CENTER

Effective Date: June 9, 2014

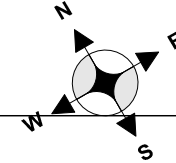

#18 Taylor To CWE  
#42 Sarah End of Line

#40 Broadway To Riverview  
#36X Bissell Hills To Redman & Hwy 367

## BROADWAY



#18 Taylor End of Line  
#42 Sarah To CWE

#40 Broadway To Catalan Loop  
#36X Bissell Hills To Compton & Spruce

ENTRANCE ONLY

PASSENGER  
WAITING  
AREA

CAR



TAYLOR

STOP



#95 Kingshighway

STOP

Pull bus to  
front bay if no  
bus present

EXIT ONLY



#70 Grand

STOP



#70 Grand

STOP

Pull bus to  
front bay if no  
bus present

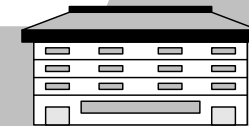

Drivers Restrooms

# NORTH HANLEY METROLINK

EFFECTIVE: December 1, 2014

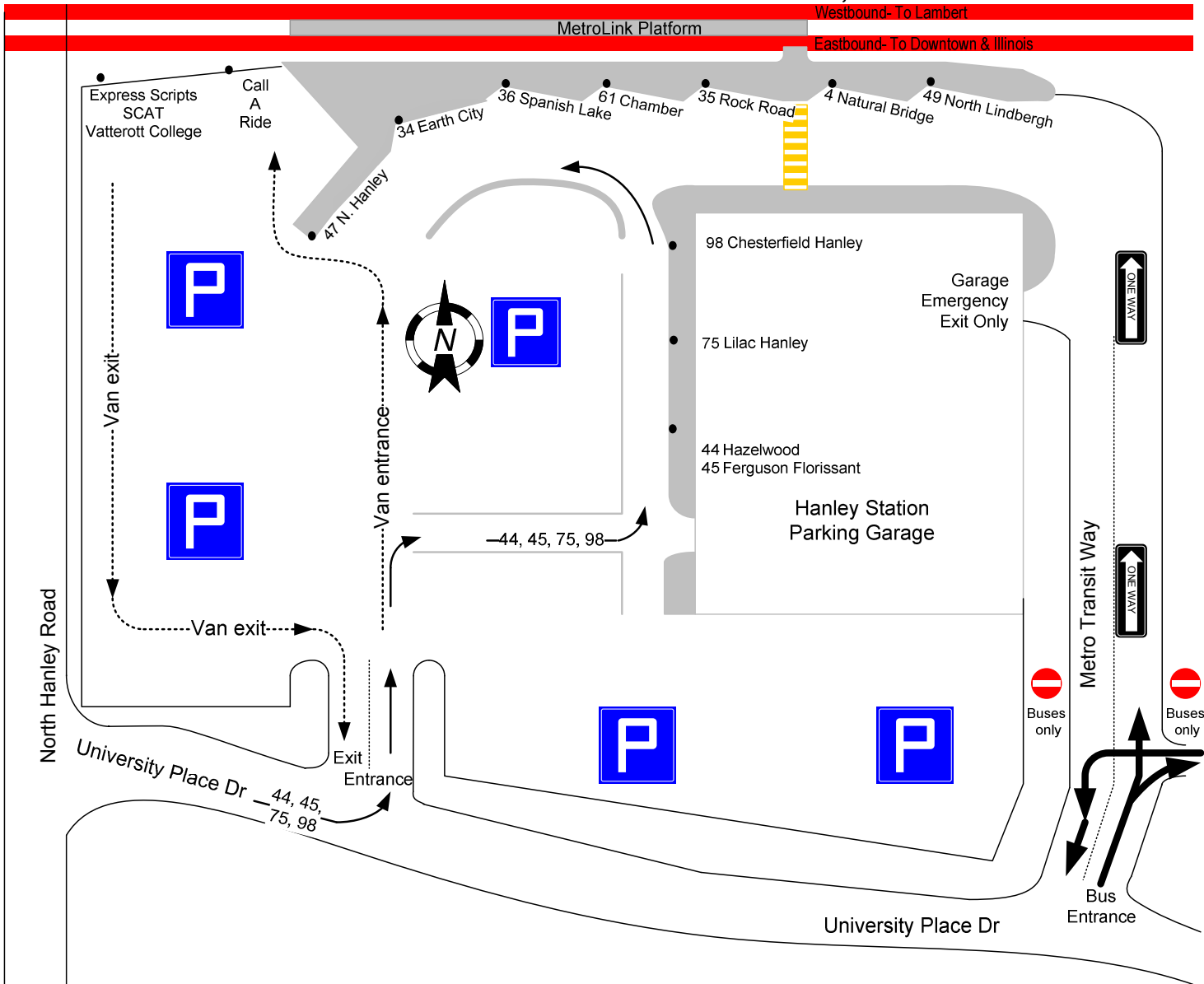



# RIVERVIEW METROBUS CENTER

Effective Date: November 29, 2010

Revised: December 6, 2010 at 9am

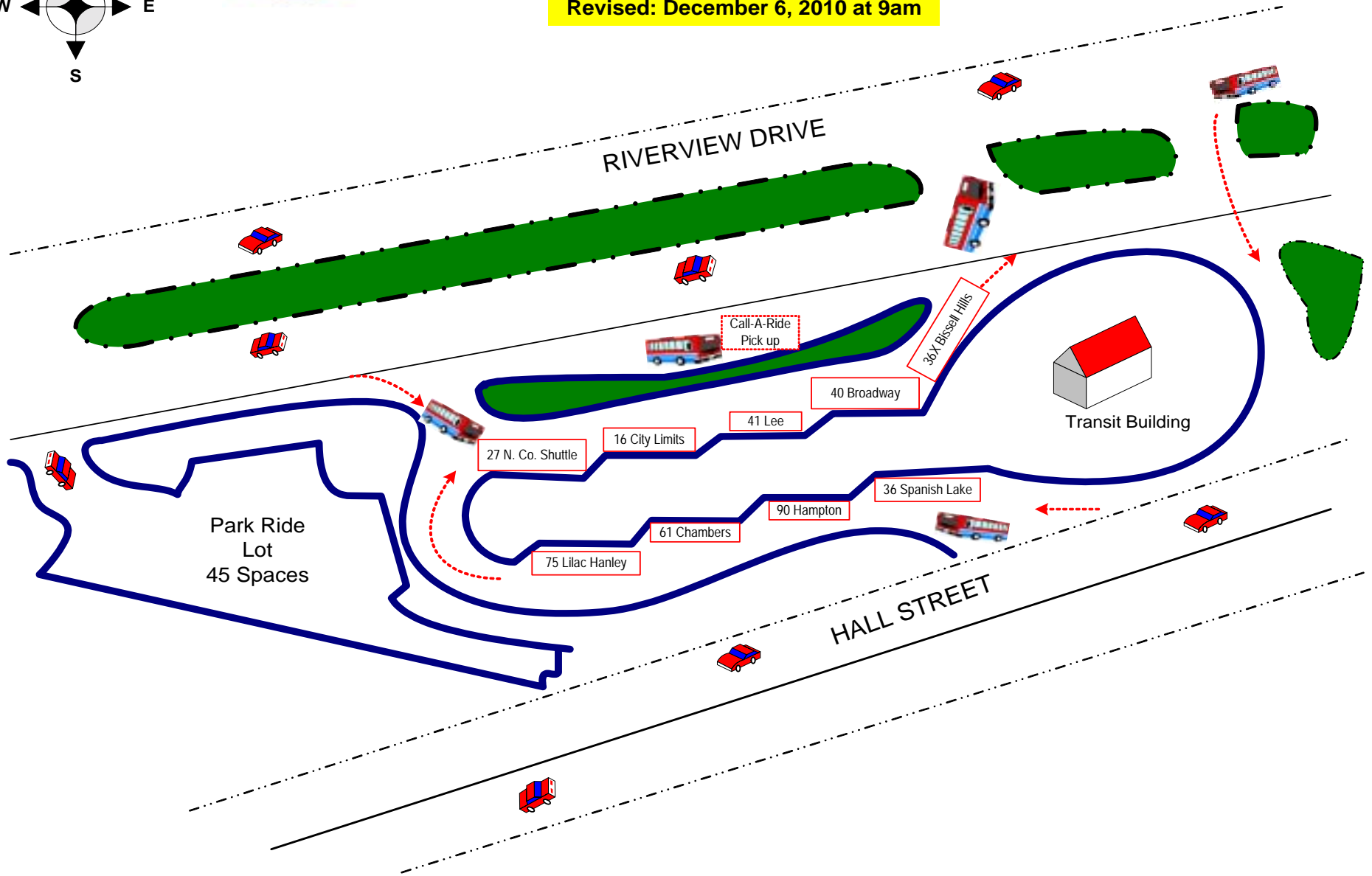
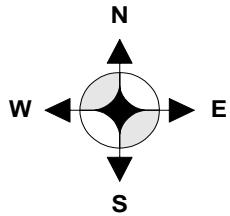

# ROCK ROAD STATION

Effective Date: October 10, 2011

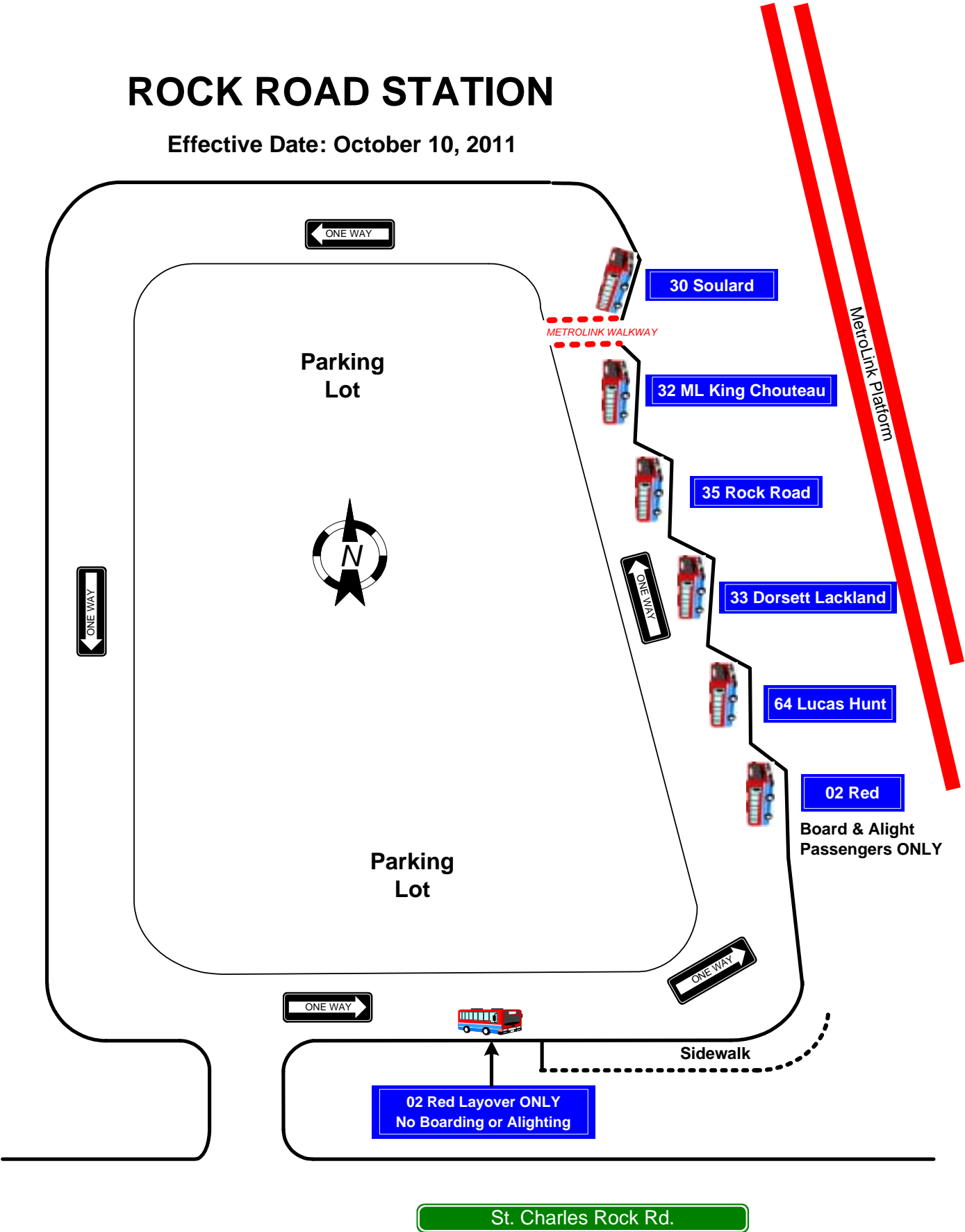



# SHREWSBURY METROBUS CENTER

Effective Date: August 30, 2010

Edward Jones to  
Maryville Campus

